

Norfolk Boreas Offshore Wind Farm Land Plans (Onshore)

Part 5 of 6
(Version 4)

DCO Document 2.2

Applicant: Norfolk Boreas Limited
Document Reference: 2.2
Deadline 18

Date: October 2020
Revision: Version 4
Author: Ardent Management Limited

Photo: Ormonde Offshore Wind Farm

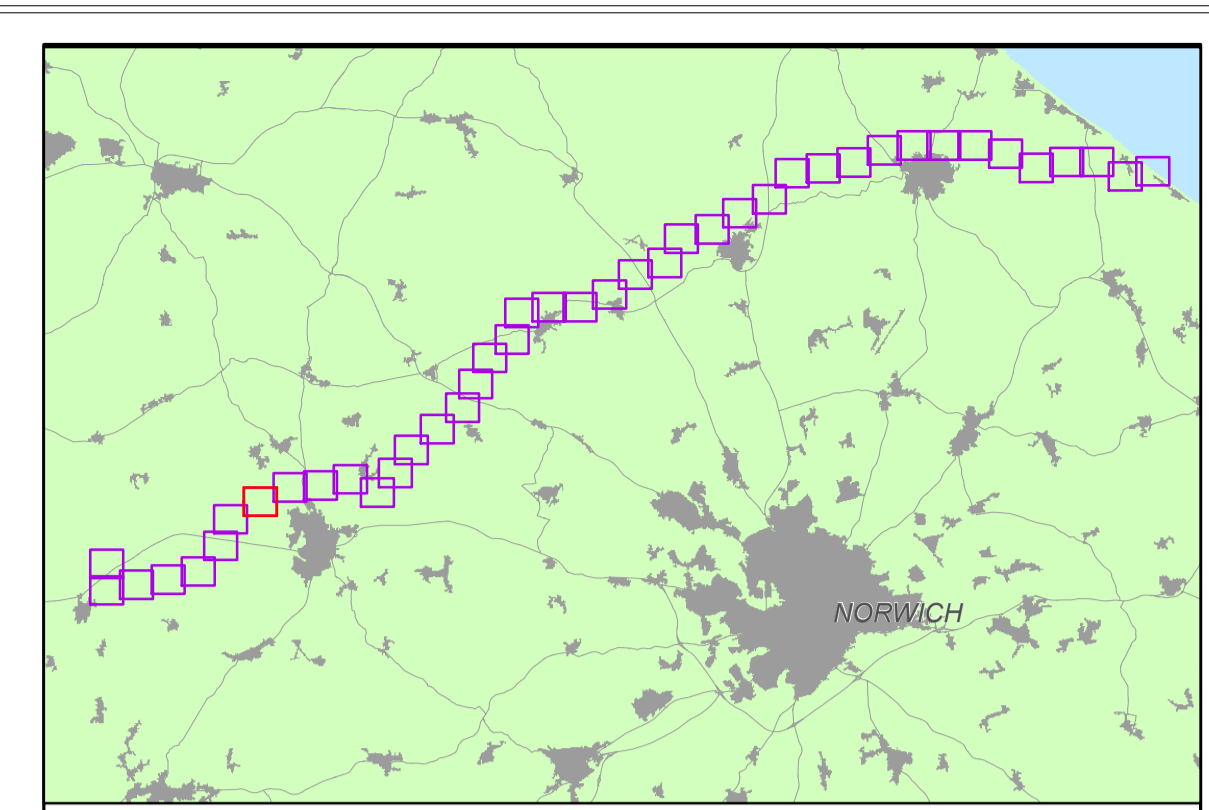
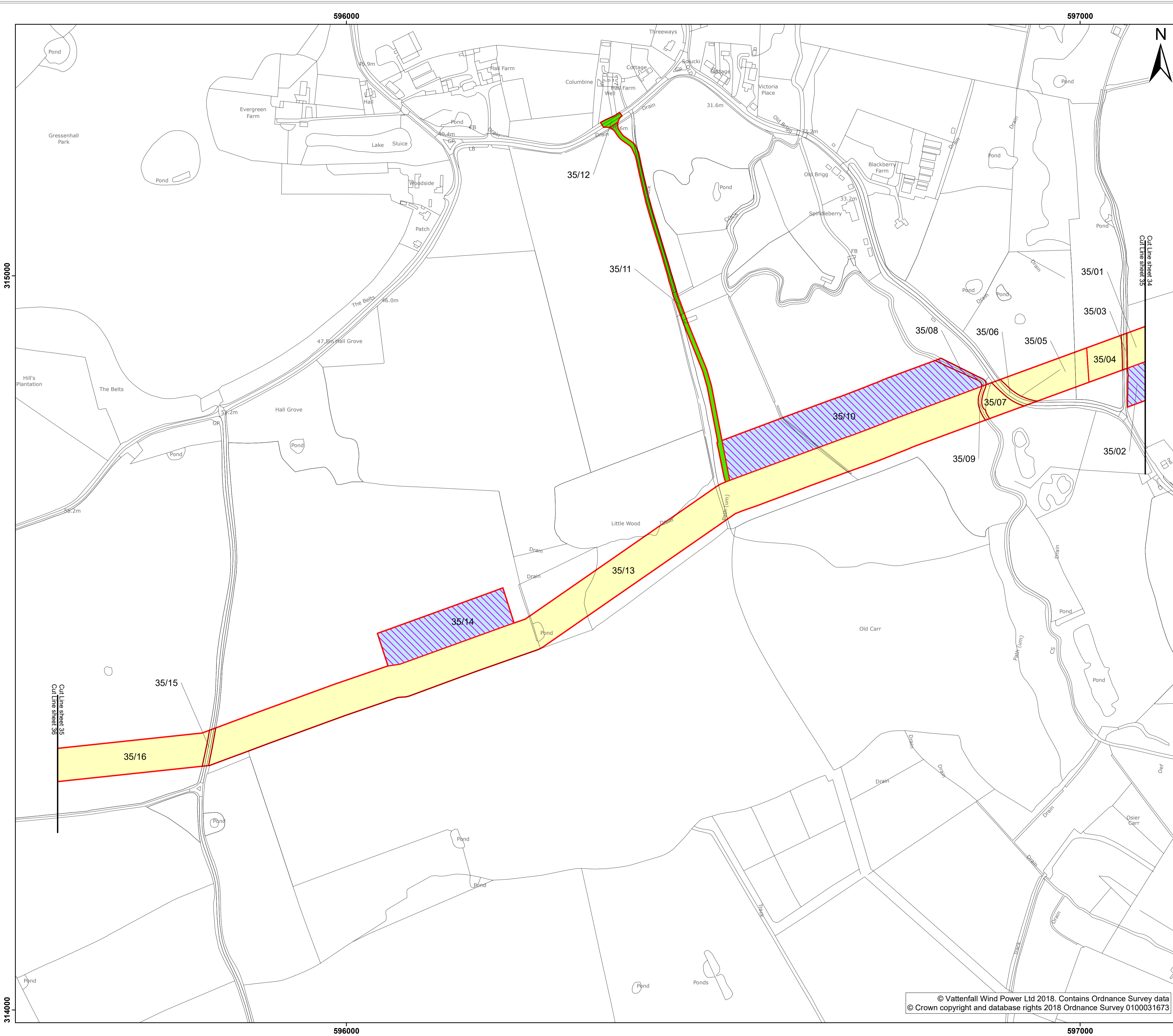

- Type of Interest Required**
- Temporary Rights
 - Acquisition of Permanent New Rights, Access Only
 - Acquisition of Permanent New Rights
- Scenario 1 and 2 Interests Differentiation Hatching**
- Type 1: Land not required under Scenario 1

Version 4 - October 2020

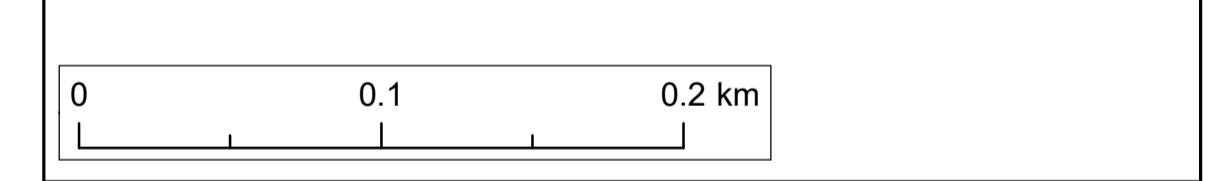

Project: Norfolk Boreas Offshore Wind Farm
 Report: Development Consent Order

Title: Land Plans
 Sheet 35

| | | | | | |
|-----------|------------|-------------------------------|----------|-------|---------|
| Doc Ref: | APFP Ref: | Drawing No: | | | |
| 2.2 | 5(2)(i) | 006_ARDG_Norfolk_B_LP_v1_Rev8 | | | |
| Revision: | Date: | Drawn: | Checked: | Size: | Scale: |
| 03 | 06/10/2020 | JH | AP | A1 | 1:2,500 |

Co-ordinate system: British National Grid EPSG: 27700



© Vattenfall Wind Power Ltd 2018. Contains Ordnance Survey data
 © Crown copyright and database rights 2018 Ordnance Survey 0100031673

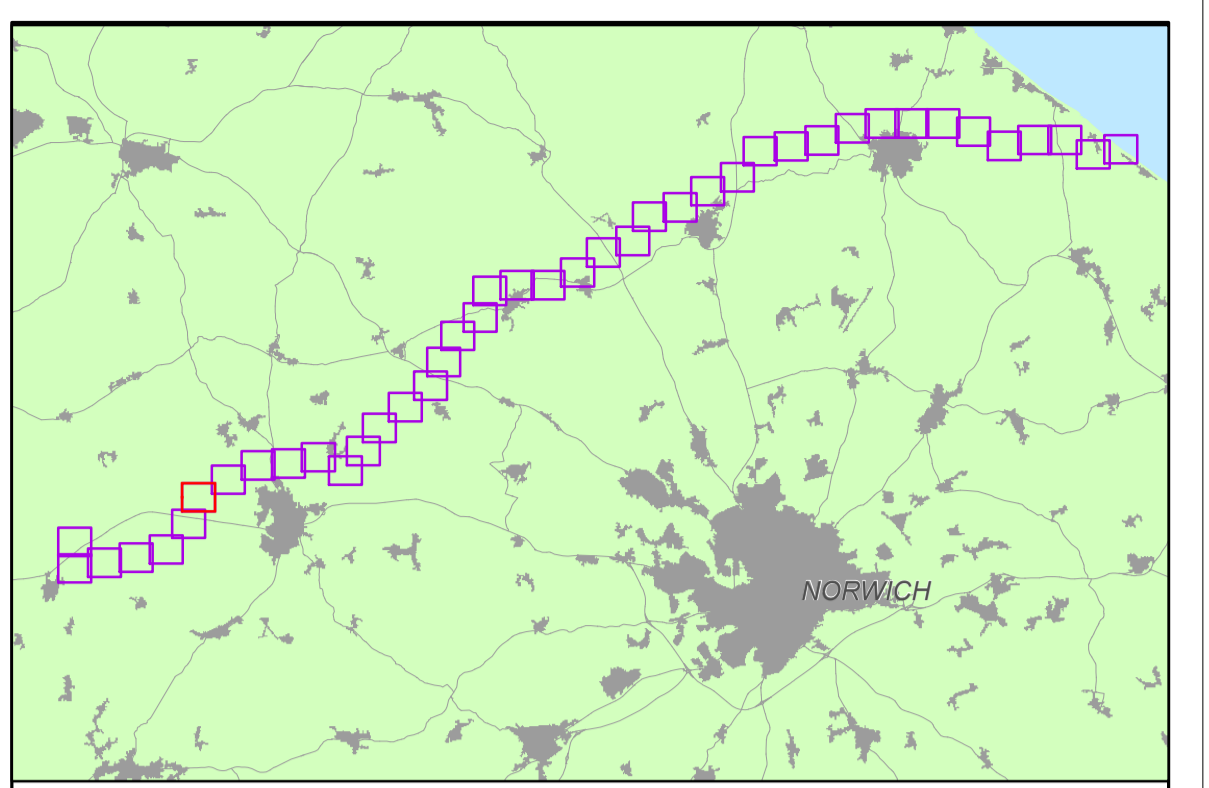
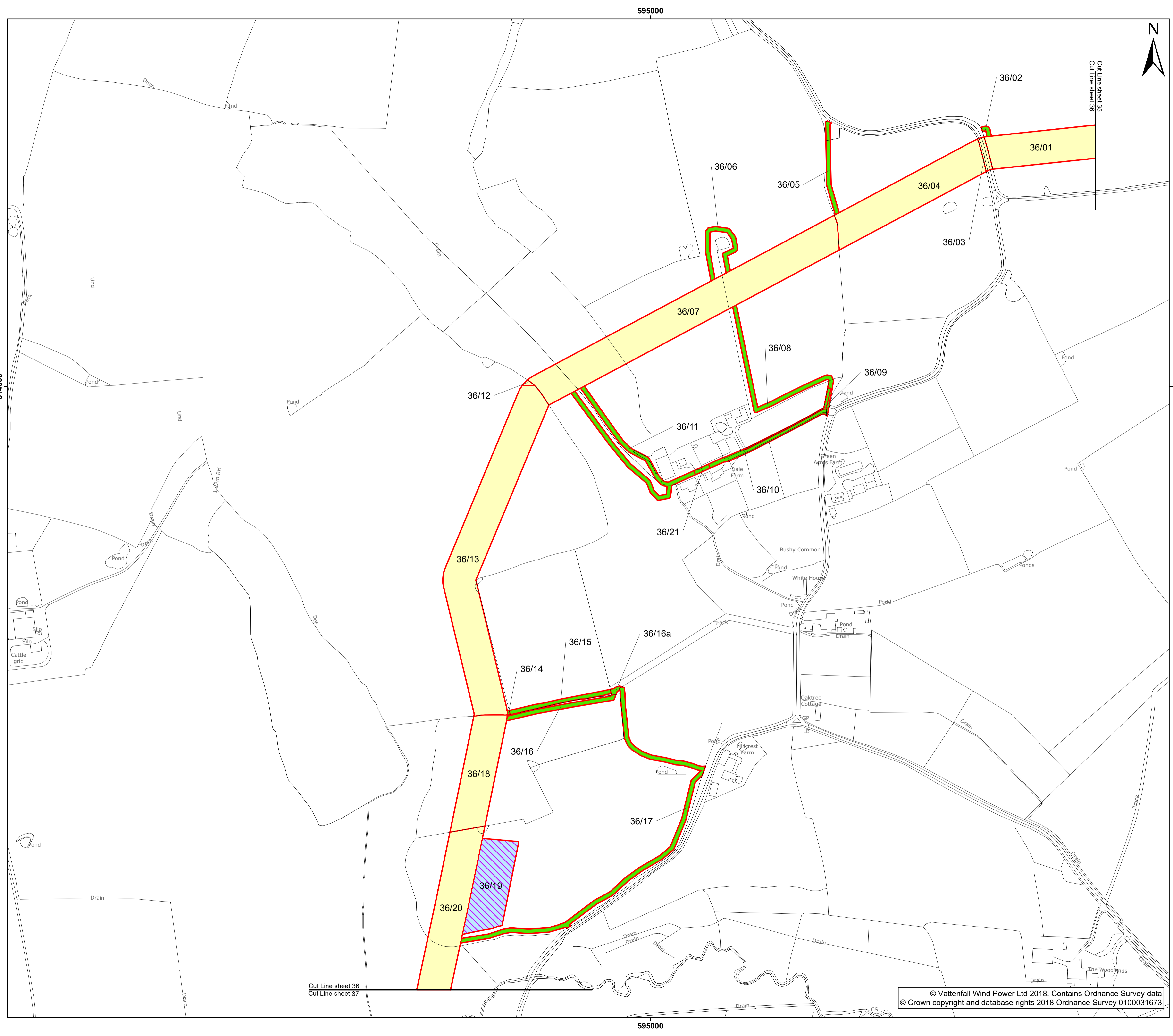

- Type of Interest Required**
- Temporary Rights
 - Acquisition of Permanent New Rights, Access Only
 - Acquisition of Permanent New Rights
- Scenario 1 and 2 Interests Differentiation Hatching**
- Type 1: Land not required under Scenario 1

Version 4 - October 2020

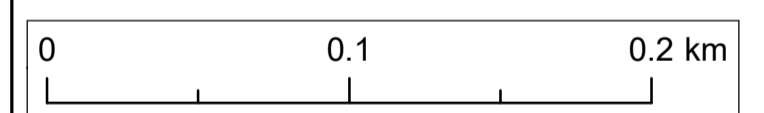

Project: Norfolk Boreas Offshore Wind Farm
 Report: Development Consent Order

Title: Land Plans
 Sheet 36

| | | | | | |
|--------------|-------------------|---|-------------|----------|----------------|
| Doc Ref: 2.2 | APFP Ref: 5(2)(i) | Drawing No: 006_ARDG_Norfolk_B_LP_v1_Rev8 | | | |
| Revision: 03 | Date: 06/10/2020 | Drawn: JH | Checked: AP | Size: A1 | Scale: 1:2,500 |

Co-ordinate system: British National Grid EPSG: 27700



© Vattenfall Wind Power Ltd 2018. Contains Ordnance Survey data © Crown copyright and database rights 2018 Ordnance Survey 0100031673

Cut Line sheet 36
 Cut Line sheet 37

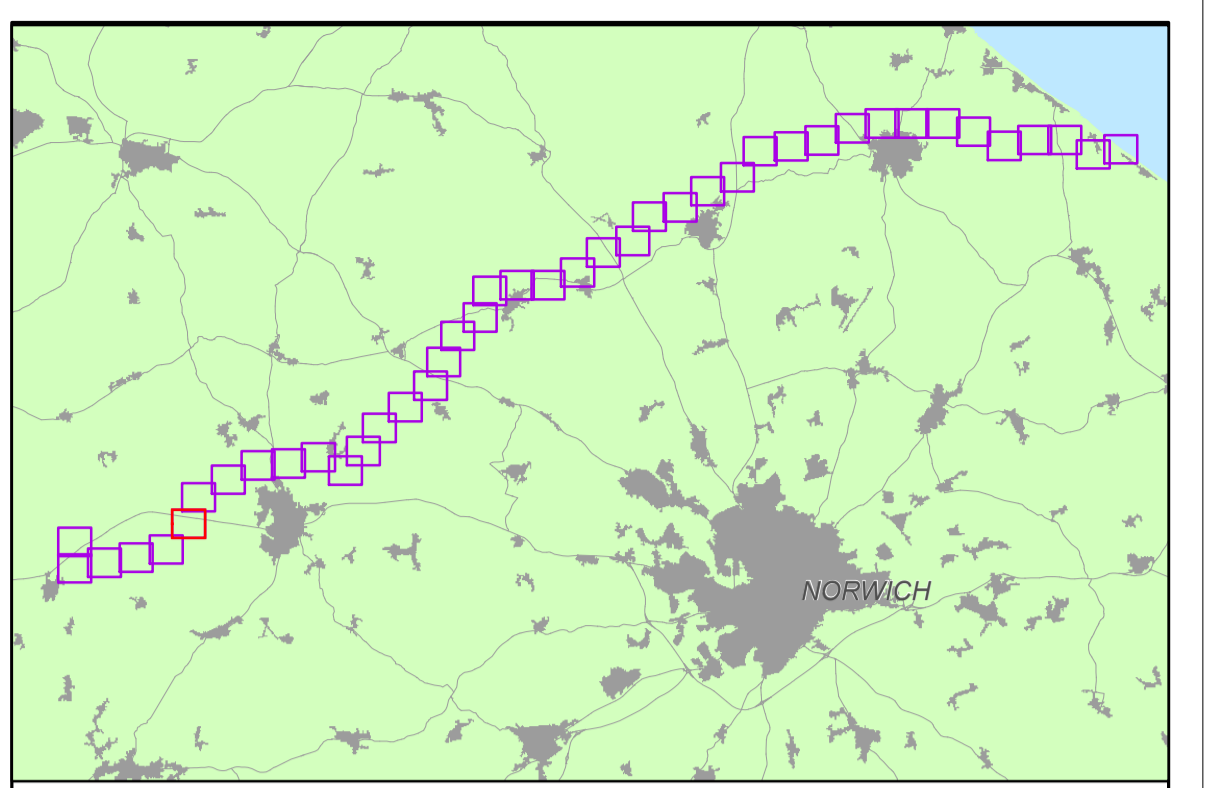
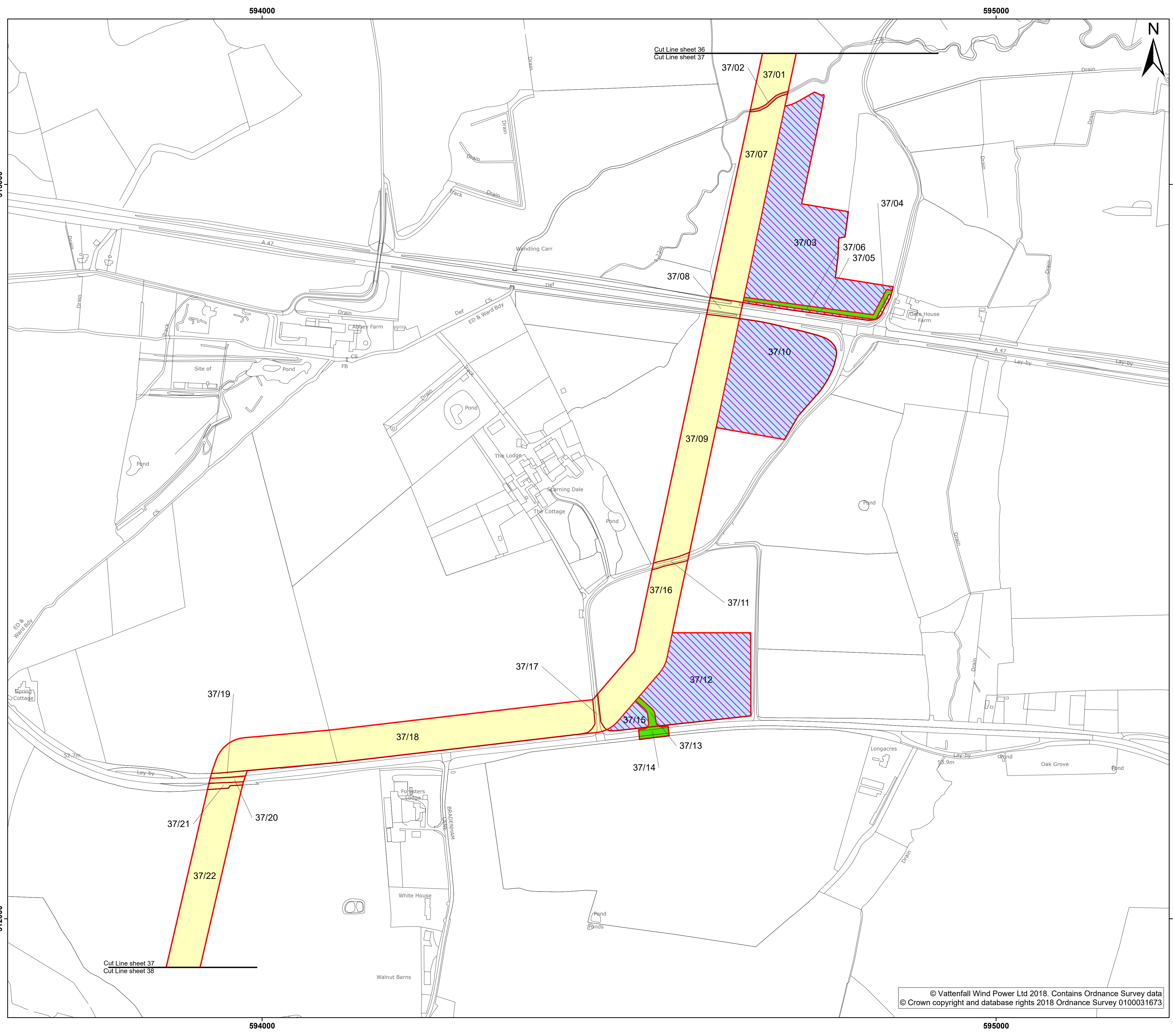

- Type of Interest Required**
- Temporary Rights
 - Acquisition of Permanent New Rights, Access Only
 - Acquisition of Permanent New Rights
- Scenario 1 and 2 Interests Differentiation Hatching**
- Type 1: Land not required under Scenario 1

Version 4 - October 2020

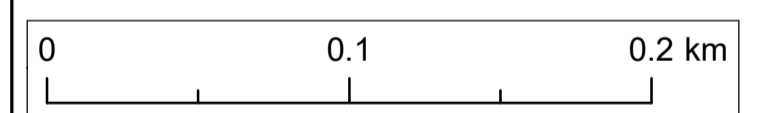

Project: Norfolk Boreas Offshore Wind Farm
 Report: Development Consent Order

Title: Land Plans
 Sheet 37

| | | | | | |
|-----------------|----------------------|--|----------------|-------------|-------------------|
| Doc Ref: 2.2 | APFP Ref: 5(2)(i) | Drawing No: 006_ARDG_Norfolk_B_LP_v1_Rev8 | | | |
| Revision: 03 | Date: 06/10/2020 | Drawn: JH | Checked: AP | Size: A1 | Scale: 1:2,500 |

Co-ordinate system: British National Grid EPSG: 27700

© Vattenfall Wind Power Ltd 2018. Contains Ordnance Survey data
 © Crown copyright and database rights 2018 Ordnance Survey 0100031673



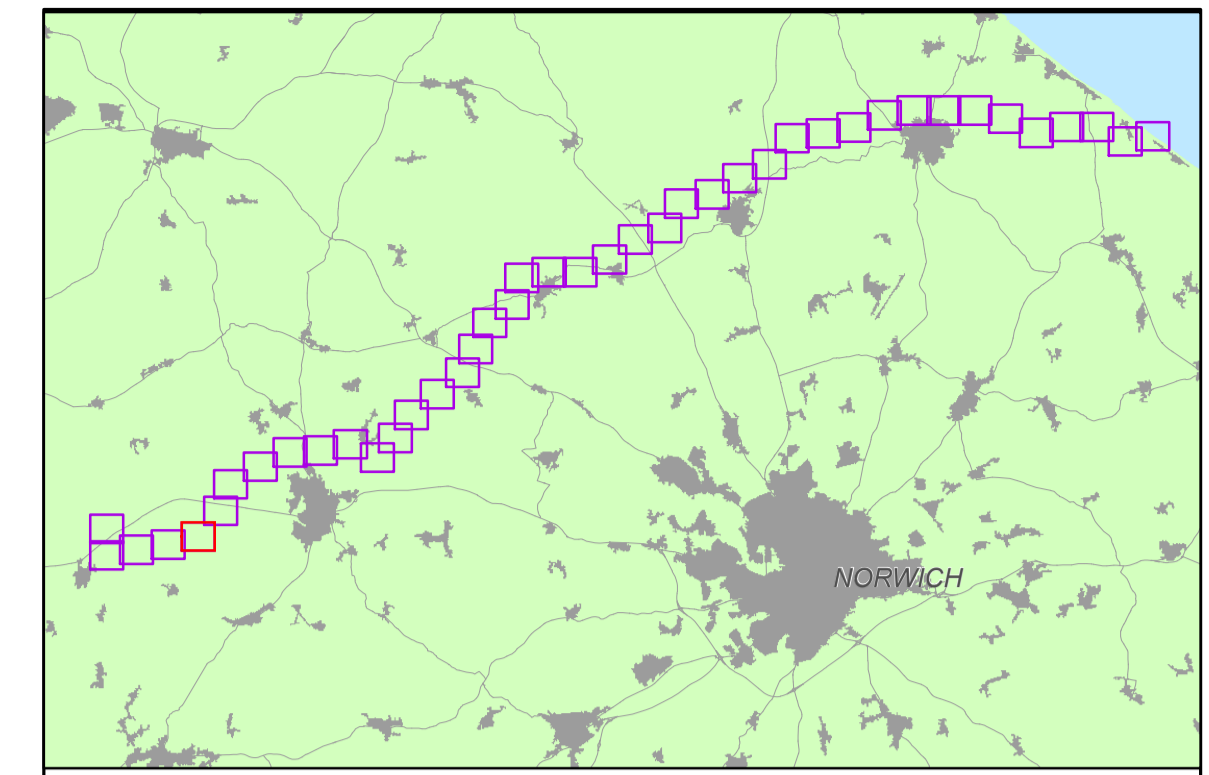
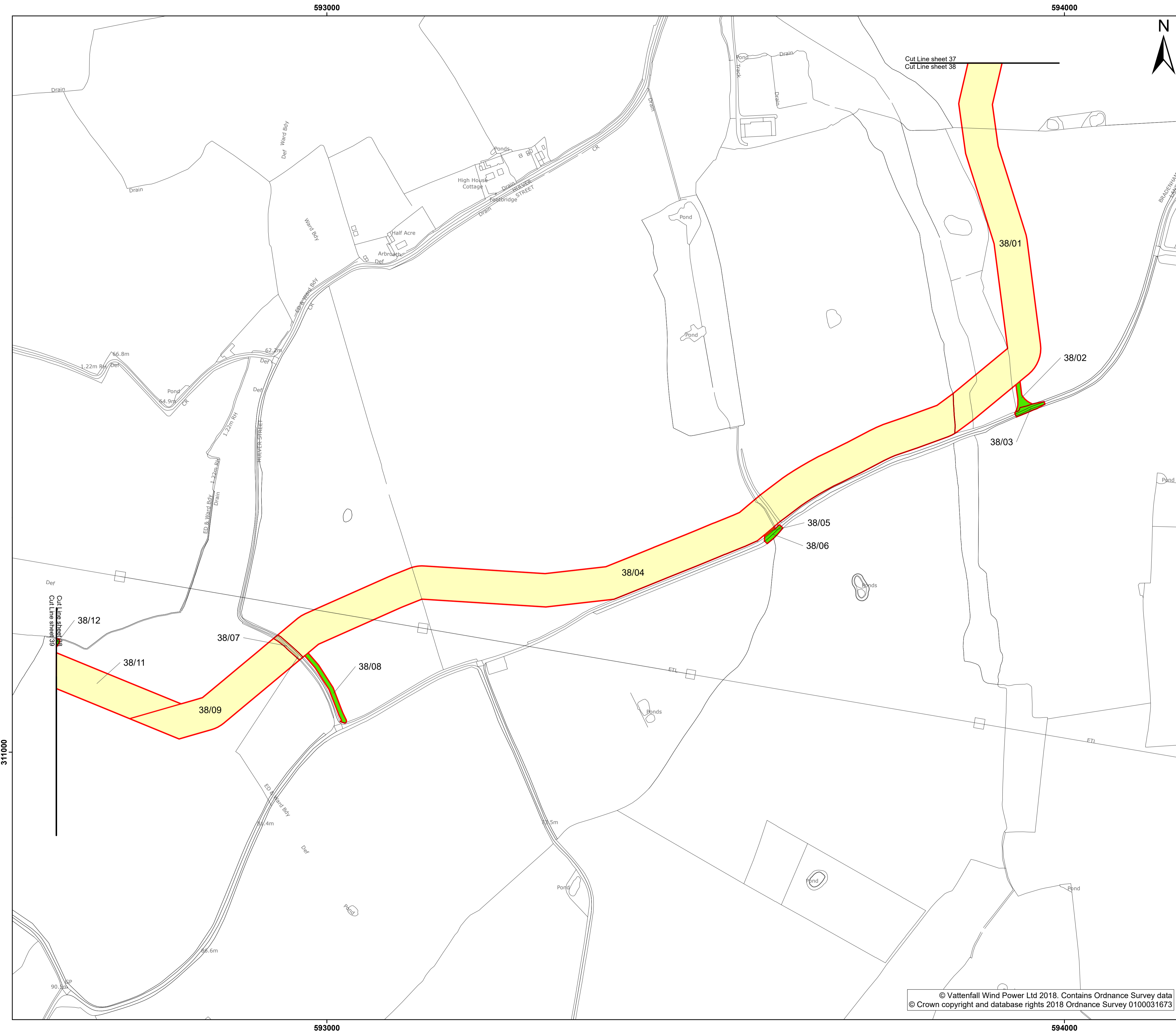

Type of Interest Required
■ Acquisition of Permanent New Rights, Access Only
■ Acquisition of Permanent New Rights

Version 4 - October 2020

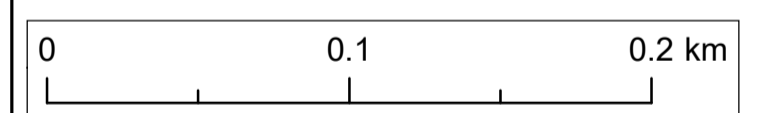

Project: Norfolk Boreas Offshore Wind Farm
 Report: Development Consent Order

Title: Land Plans
 Sheet 38

| | | | | | |
|-----------------|----------------------|--|----------------|-------------|-------------------|
| Doc Ref: 2.2 | APFP Ref: 5(2)(i) | Drawing No: 006_ARDG_Norfolk_B_LP_v1_Rev8 | | | |
| Revision: 03 | Date: 06/10/2020 | Drawn: JH | Checked: AP | Size: A1 | Scale: 1:2,500 |

Co-ordinate system: British National Grid EPSG: 27700

© Vattenfall Wind Power Ltd 2018. Contains Ordnance Survey data
 © Crown copyright and database rights 2018 Ordnance Survey 0100031673



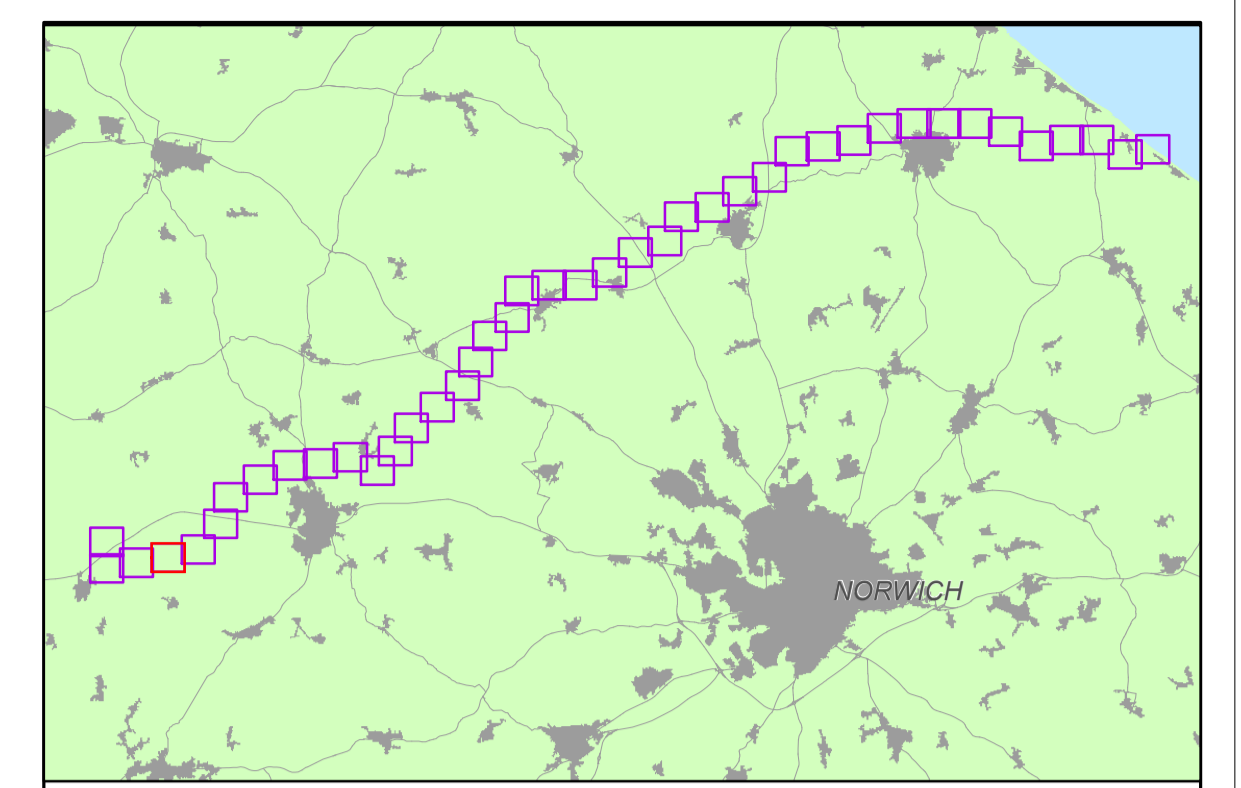
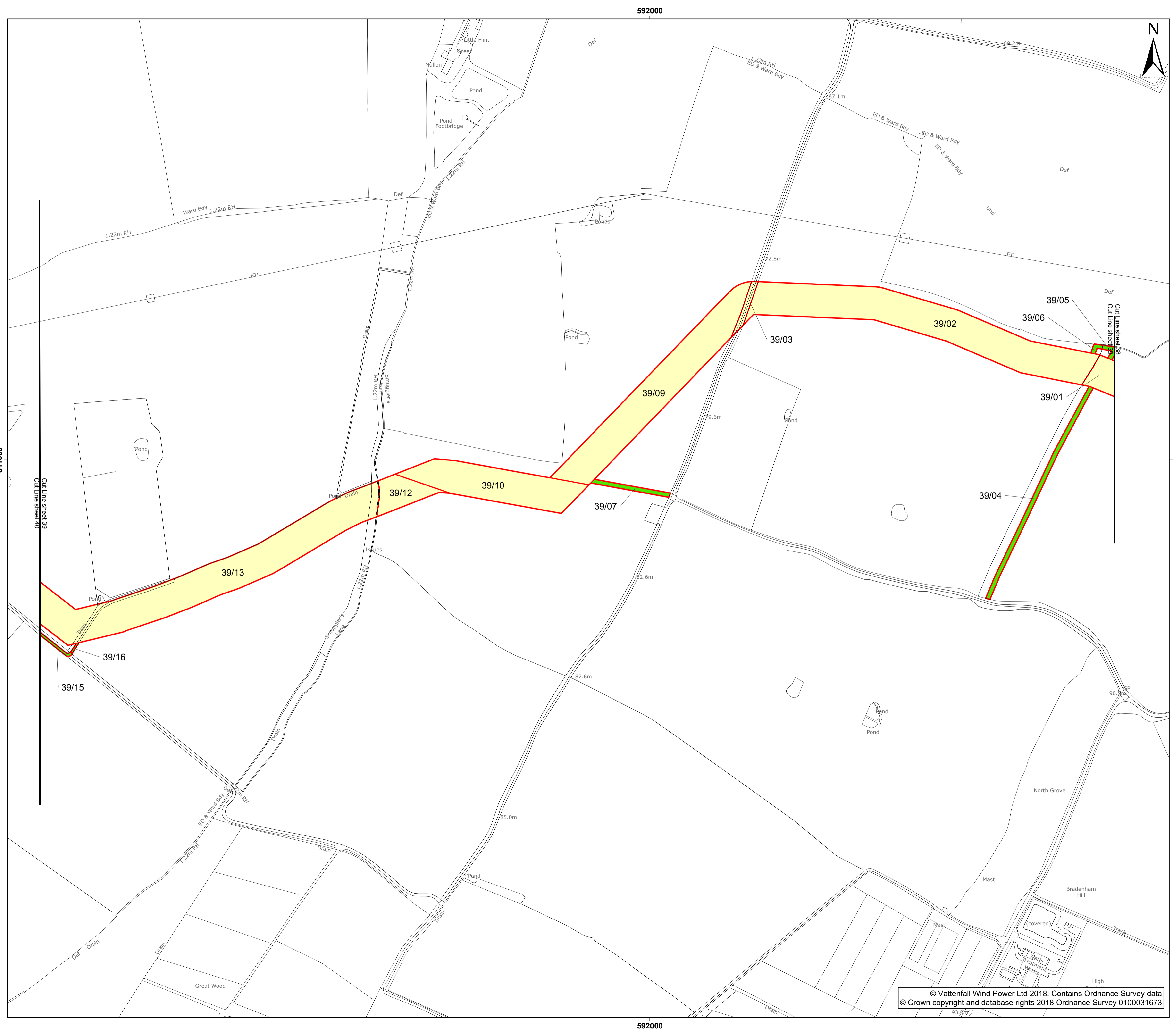

Type of Interest Required

- Acquisition of Permanent New Rights, Access Only
- Acquisition of Permanent New Rights

Version 4 - October 2020

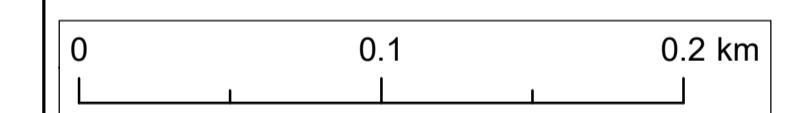

| | |
|---|---|
| Project: Norfolk Boreas Offshore Wind Farm | Report: Development Consent Order |
|---|---|

Title:
Land Plans
Sheet 39

| | | | | | |
|------------------------|-----------------------------|---|-----------------------|--------------------|--------------------------|
| Doc Ref: 2.2 | APFP Ref: 5(2)(i) | Drawing No: 006_ARDG_Norfolk_B_LP_v1_Rev8 | | | |
| Revision: 03 | Date: 06/10/2020 | Drawn: JH | Checked: AP | Size: A1 | Scale: 1:2,500 |

Co-ordinate system: British National Grid **EPSG:** 27700

© Vattenfall Wind Power Ltd 2018. Contains Ordnance Survey data
© Crown copyright and database rights 2018 Ordnance Survey 0100031673



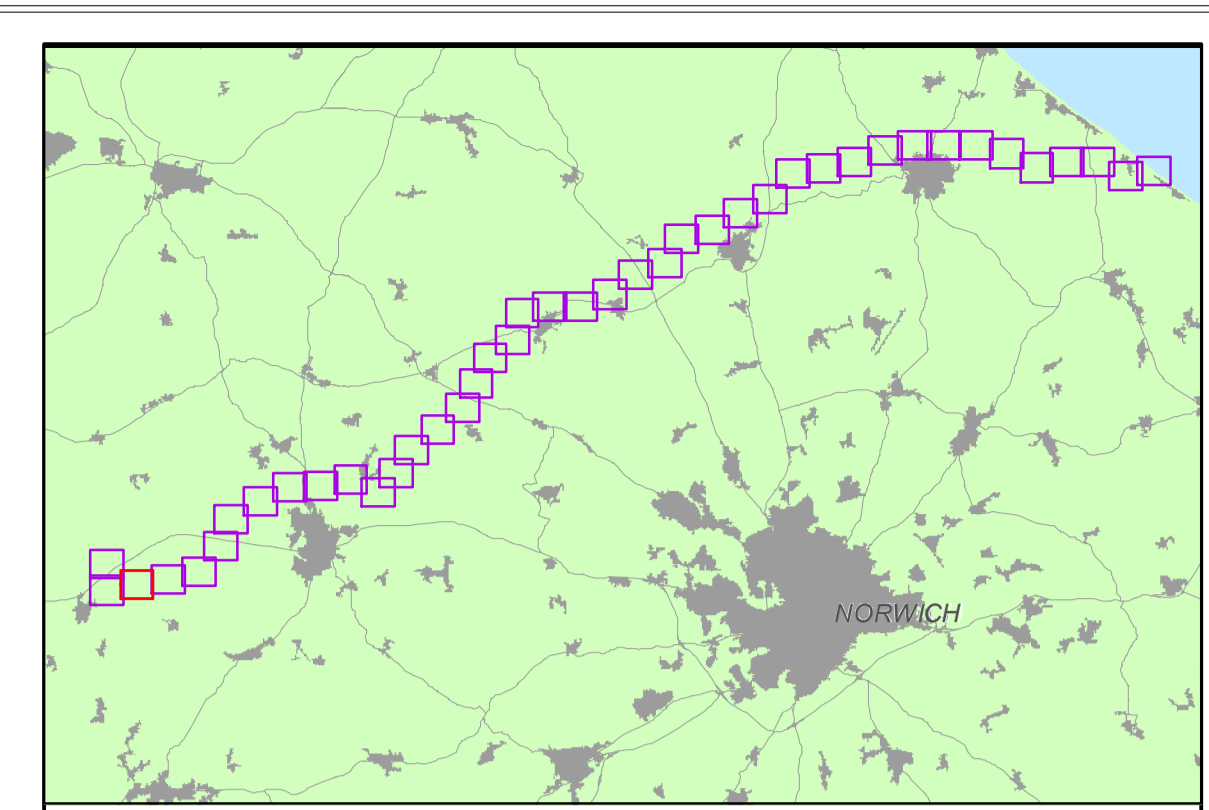
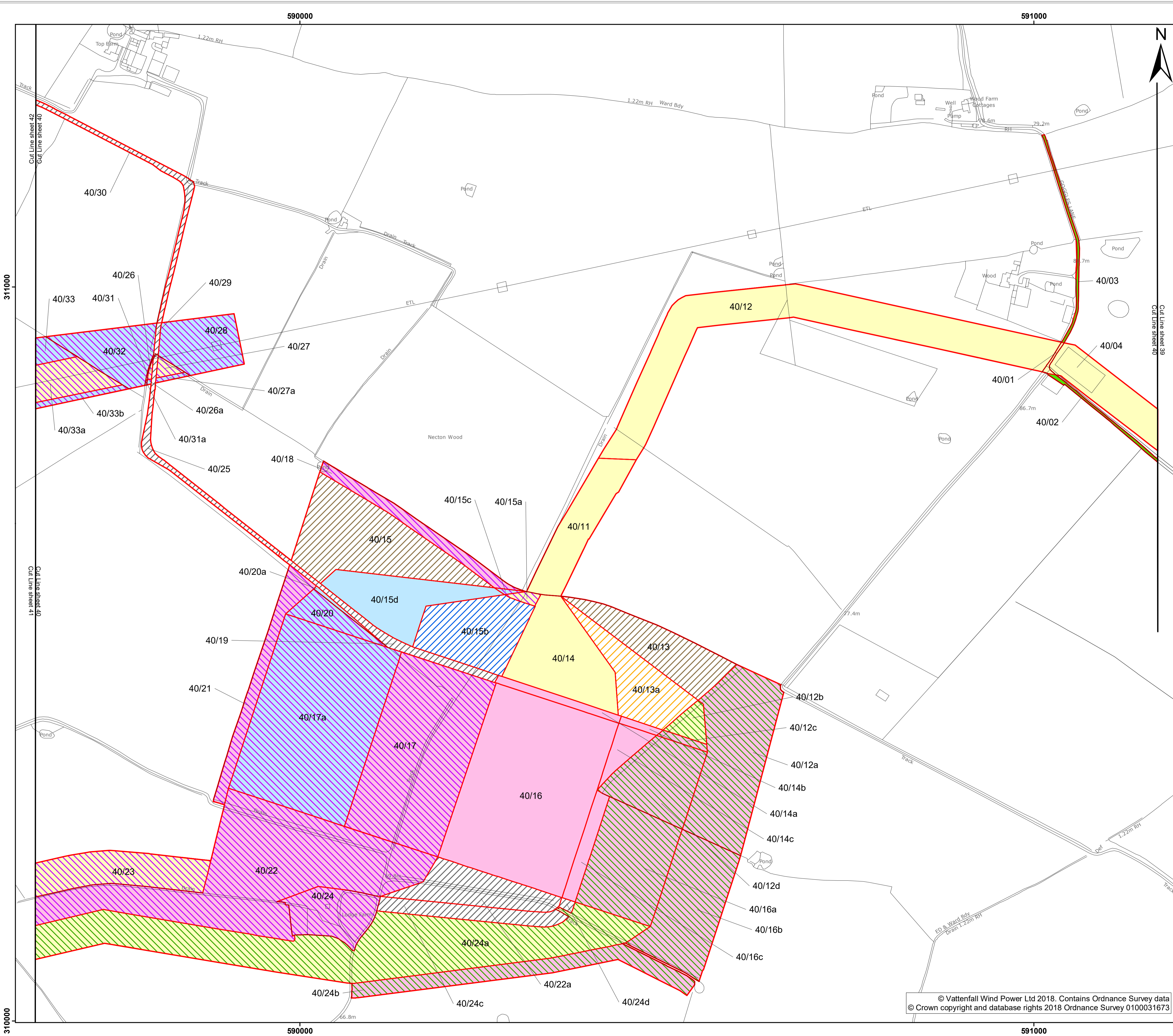

- Type of Interest Required**
- Temporary Rights
 - Acquisition of Permanent New Rights, Access Only
 - Permanent Freehold Acquisition
 - Acquisition of Permanent New Rights
- Scenario 1 and 2 Interests Differentiation Hatching**
- Type 1: Land not required under Scenario 1
 - Type 2: Land not required under Scenario 2
 - Type 3: Permanent rights under Scenario 1, Permanent Acquisition under Scenario 2
 - Type 6: Temporary rights under Scenario 1, Permanent acquisition under Scenario 2
 - Type 7: Temporary rights under Scenario 1, Permanent rights under Scenario 2
 - Type 8: Permanent rights under Scenario 1, Temporary rights under Scenario 2

Version 4 - October 2020

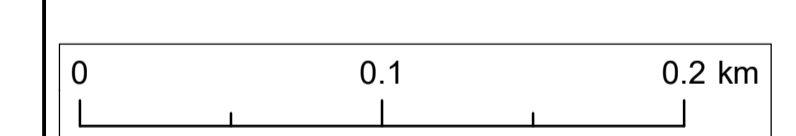

| | |
|--|--------------------------------------|
| Project: Norfolk Boreas Offshore Wind Farm | Report: Development Consent Order |
|--|--------------------------------------|

Title:
**Land Plans
Both Scenarios Overview
Sheet 40**

| | | |
|-----------------|----------------------|--|
| Doc Ref: 2.2 | APFP Ref: 5(2)(i) | Drawing No: 006_ARDG_Norfolk_B_LP_v1_Rev8 |
| Revision: 03 | Date: 07/10/2020 | Drawn: JH |
| | Checked: AP | Size: A1 |
| | | Scale: 1:2,500 |

Co-ordinate system: British National Grid EPSG: 27700



© Vattenfall Wind Power Ltd 2018. Contains Ordnance Survey data
© Crown copyright and database rights 2018 Ordnance Survey 0100031673

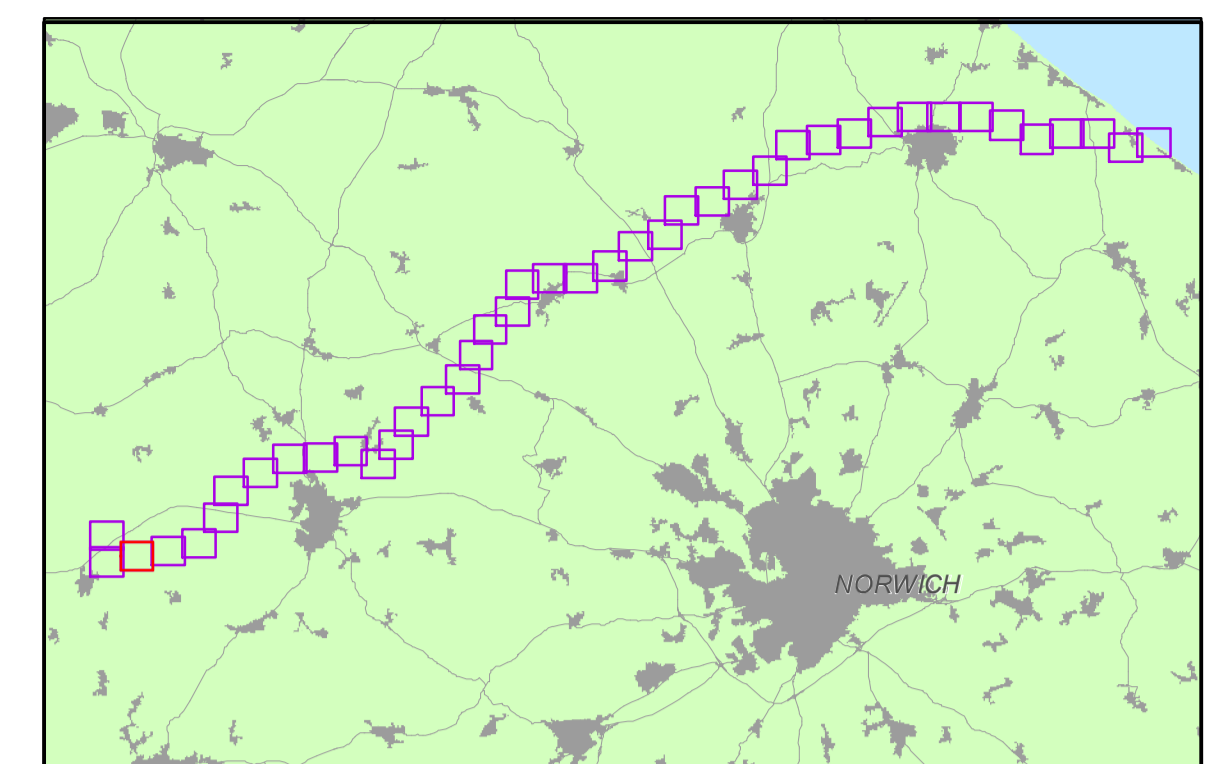
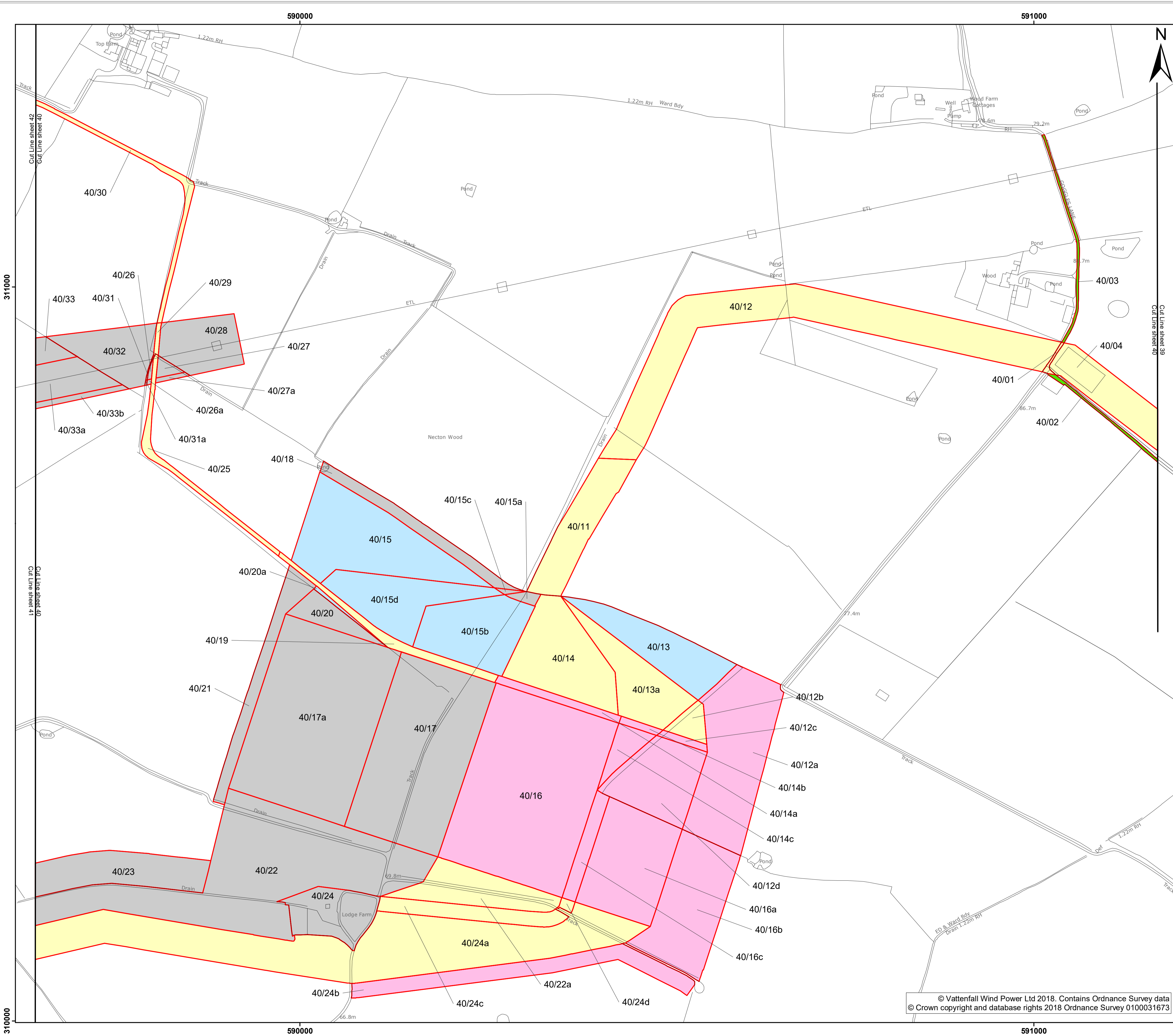

- Type of Interest Required**
- Temporary Rights
 - Acquisition of Permanent New Rights, Access Only
 - Permanent Freehold Acquisition
 - Acquisition of Permanent New Rights
 - Land not required

Version 4 - October 2020

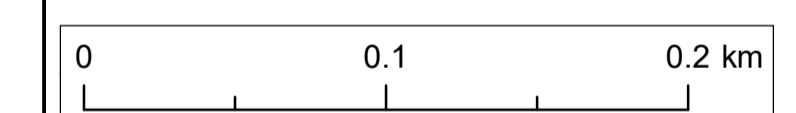

| | |
|--|--------------------------------------|
| Project: Norfolk Boreas Offshore Wind Farm | Report: Development Consent Order |
|--|--------------------------------------|

Title: **Land Plans Scenario 1 Sheet 40a**

| | | |
|-----------------|----------------------|--|
| Doc Ref: 2.2 | APFP Ref: 5(2)(i) | Drawing No: 006_ARDG_Norfolk_B_LP_S140a42a_Rev8 |
| Revision: 03 | Date: 07/10/2020 | Drawn: JH |
| Checked: AP | Size: A1 | Scale: 1:2,500 |

Co-ordinate system: British National Grid EPSG: 27700

© Vattenfall Wind Power Ltd 2018. Contains Ordnance Survey data
© Crown copyright and database rights 2018 Ordnance Survey 0100031673



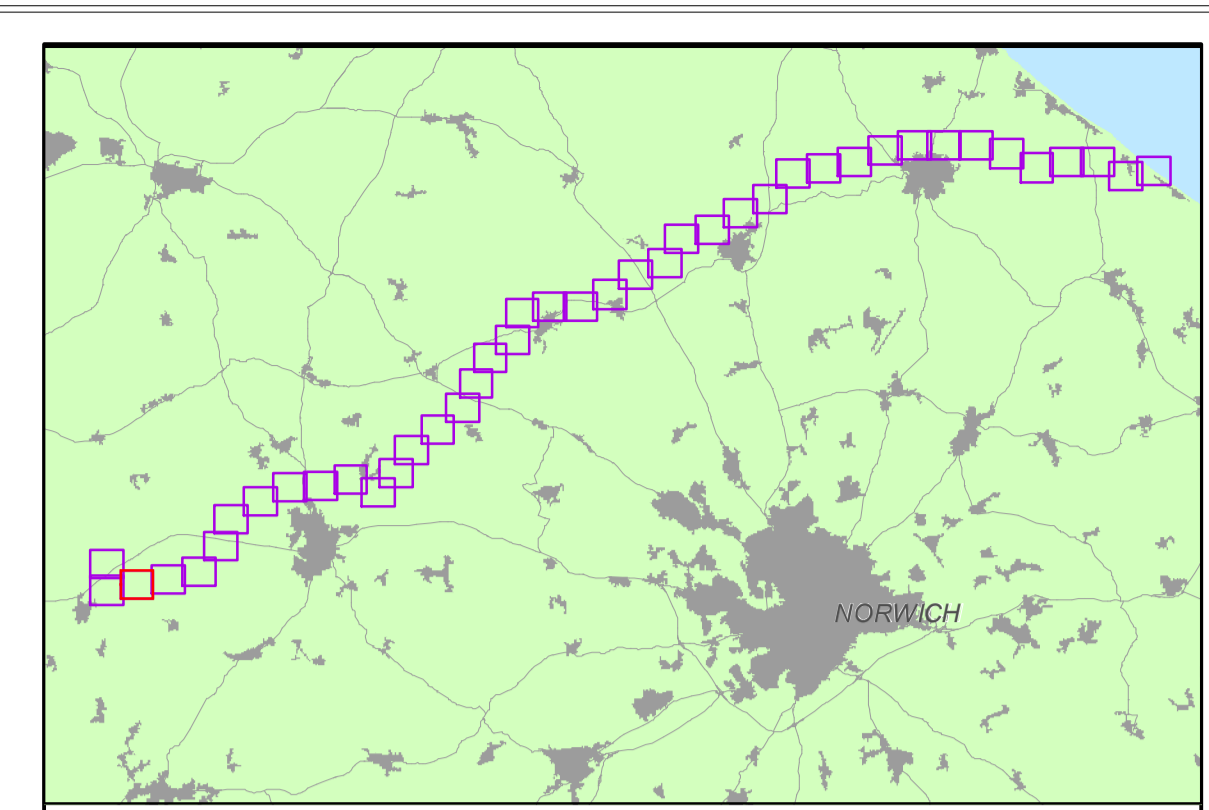
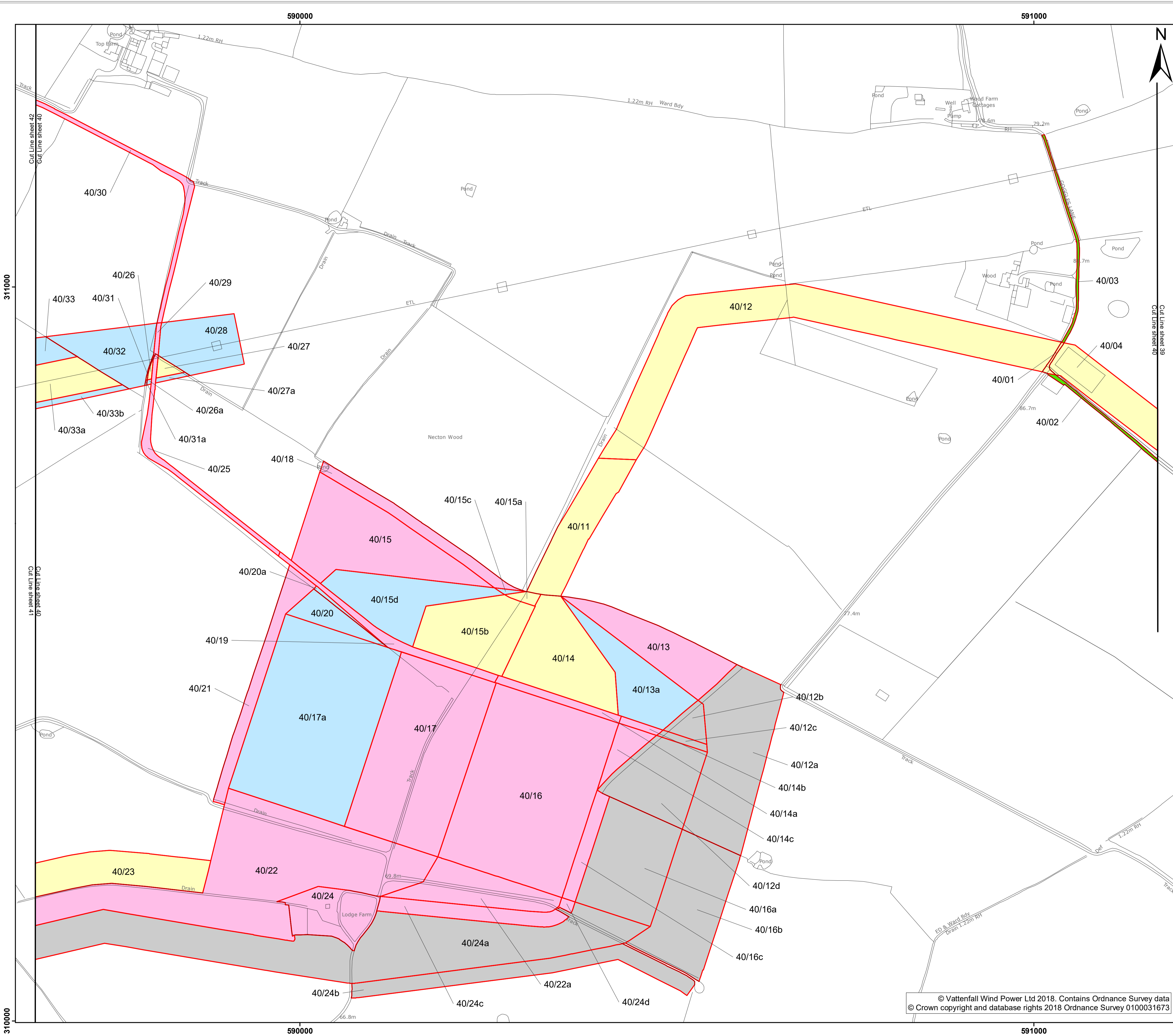

- Type of Interest Required**
- Temporary Rights
 - Acquisition of Permanent New Rights, Access Only
 - Permanent Freehold Acquisition
 - Acquisition of Permanent New Rights
 - Land not required

Version 4 - October 2020

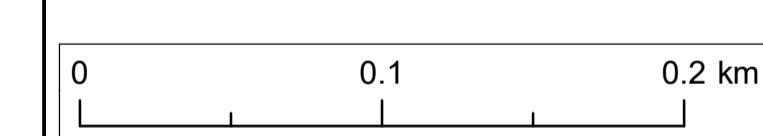

Project: Norfolk Boreas Offshore Wind Farm
 Report: Development Consent Order

Title: Land Plans Scenario 2 Sheet 40b

| | | | | | |
|--------------|-------------------|---|-------------|----------|----------------|
| Doc Ref: 2.2 | APFP Ref: 5(2)(i) | Drawing No: 006_ARDG_Norfolk_B_LP_S240b42b_Rev8 | | | |
| Revision: 03 | Date: 07/10/2020 | Drawn: JH | Checked: AP | Size: A1 | Scale: 1:2,500 |

Co-ordinate system: British National Grid EPSG: 27700



© Vattenfall Wind Power Ltd 2018. Contains Ordnance Survey data © Crown copyright and database rights 2018 Ordnance Survey 0100031673

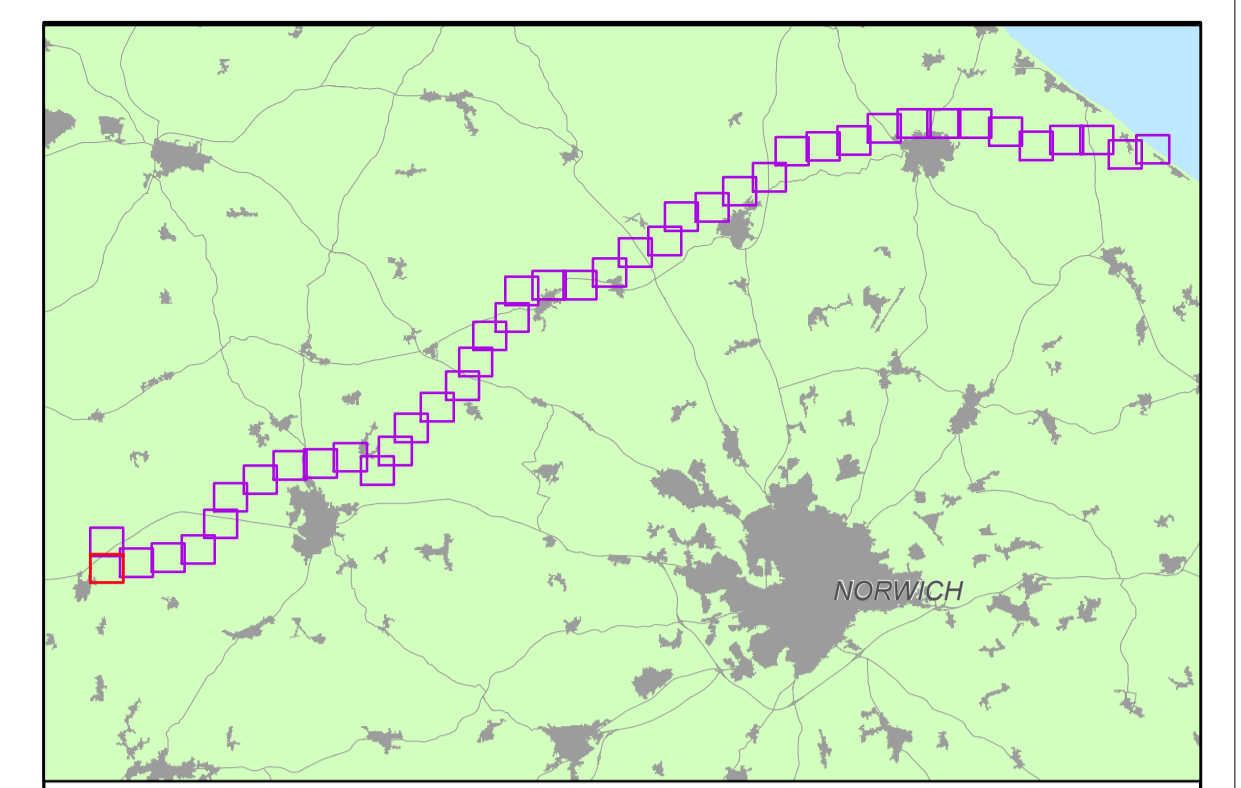
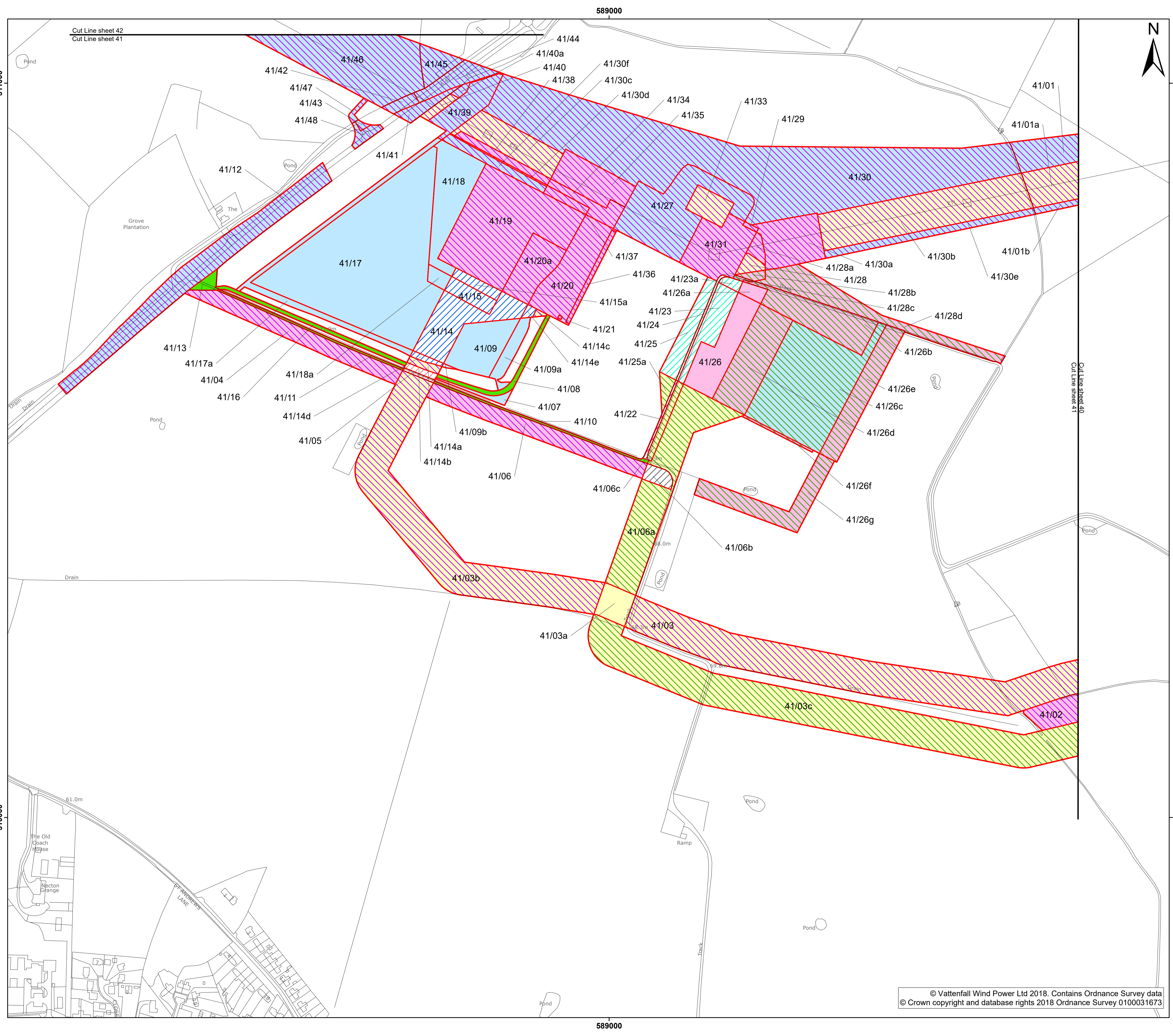

- Type of Interest Required**
- Temporary Rights
 - Acquisition of Permanent New Rights, Access Only
 - Permanent Freehold Acquisition
 - Acquisition of Permanent New Rights
- Scenario 1 and 2 Interests Differentiation Hatching**
- Type 1: Land not required under Scenario 1
 - Type 2: Land not required under Scenario 2
 - Type 3: Permanent rights under Scenario 1, Permanent Acquisition under Scenario 2
 - Type 4: Permanent rights under Scenario 1, Access only under Scenario 2
 - Type 5: Permanent acquisition under Scenario 1, Permanent rights under Scenario 2
 - Type 7: Temporary rights under Scenario 1, Permanent rights under Scenario 2
 - Type 9: Access only under Scenario 1, Permanent rights under Scenario 2

Version 4 - October 2020

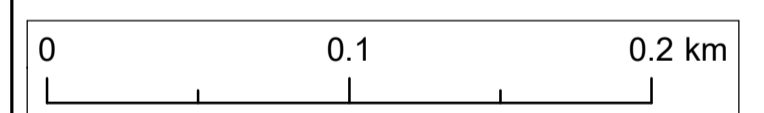

Project: Norfolk Boreas Offshore Wind Farm
 Report: Development Consent Order

Title: Land Plans
 Both Scenarios Overview
 Sheet 41

| | | | | | |
|--------------|-------------------|---|-------------|----------|----------------|
| Doc Ref: 2.2 | APFP Ref: 5(2)(i) | Drawing No: 006_ARDG_Norfolk_B_LP_v1_Rev8 | | | |
| Revision: 03 | Date: 06/10/2020 | Drawn: JH | Checked: AP | Size: A1 | Scale: 1:2,500 |

Co-ordinate system: British National Grid EPSG: 27700

© Vattenfall Wind Power Ltd 2018. Contains Ordnance Survey data
 © Crown copyright and database rights 2018 Ordnance Survey 0100031673



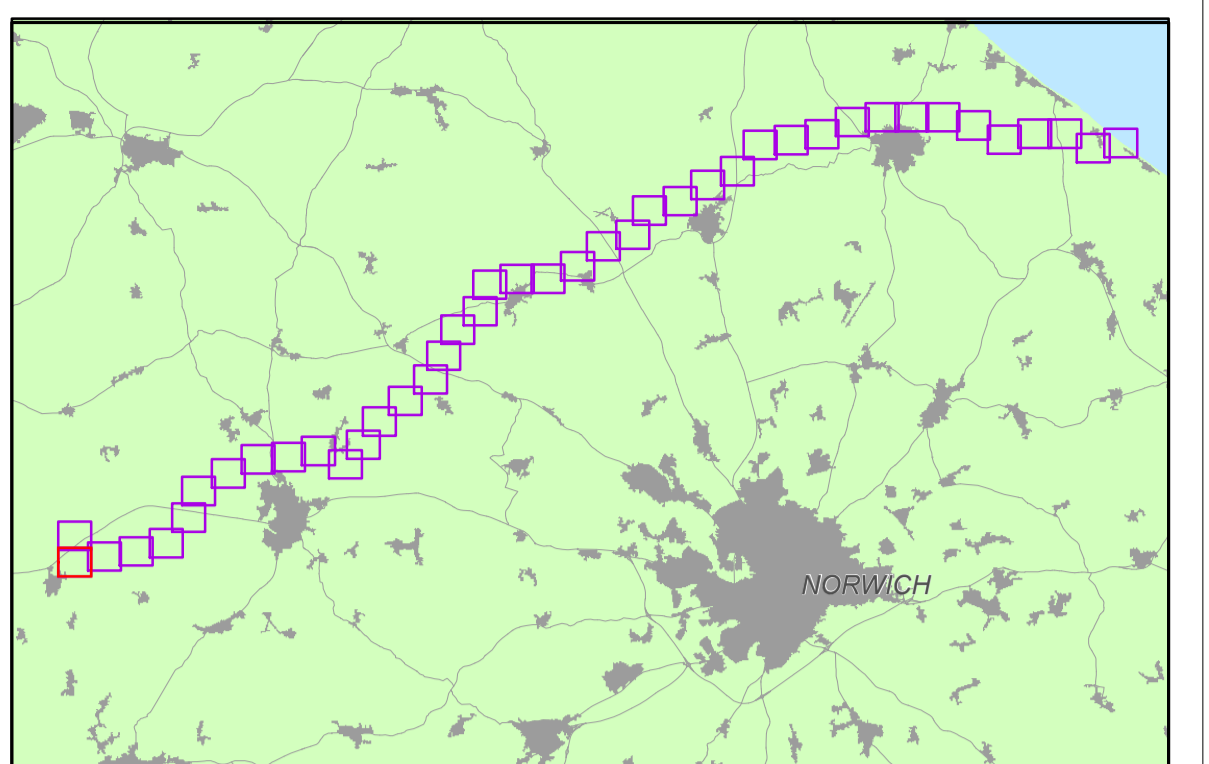
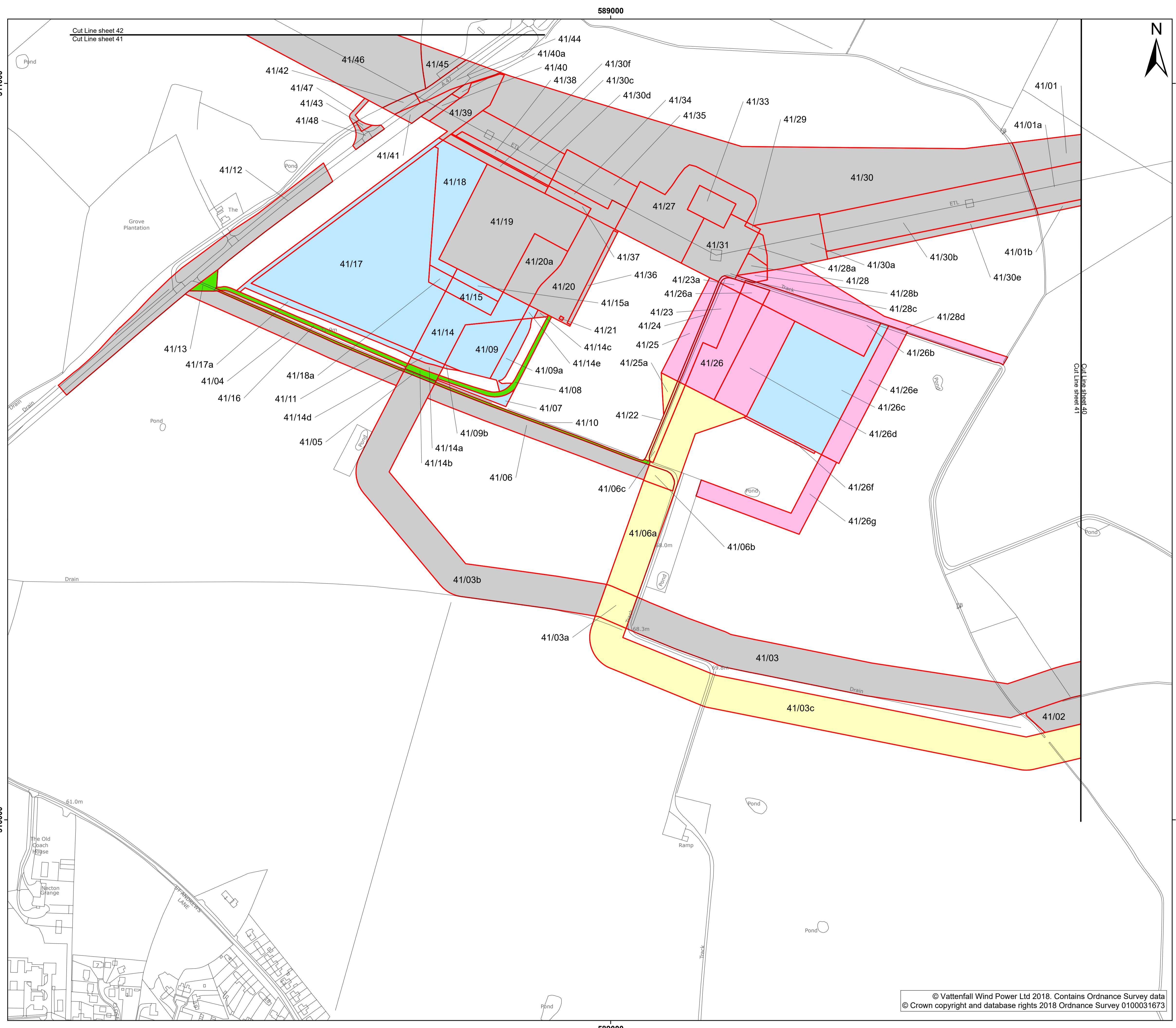

- Type of Interest Required**
- Temporary Rights
 - Acquisition of Permanent New Rights, Access Only
 - Permanent Freehold Acquisition
 - Acquisition of Permanent New Rights
 - Land not required

Version 4 - October 2020

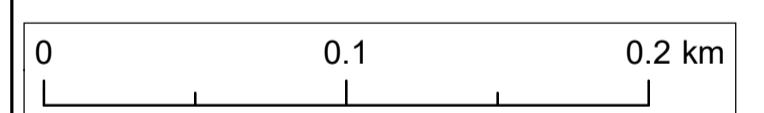

| | |
|--|--------------------------------------|
| Project: Norfolk Boreas Offshore Wind Farm | Report: Development Consent Order |
|--|--------------------------------------|

Title:
**Land Plans
Scenario 1
Sheet 41a**

| | | | | | |
|-----------------|----------------------|--|----------------|-------------|-------------------|
| Doc Ref: 2.2 | APFP Ref: 5(2)(i) | Drawing No: 006_ARDG_Norfolk_B_LP_S140a42a_Rev8 | | | |
| Revision: 00 | Date: 06/10/2020 | Drawn: JH | Checked: AP | Size: A1 | Scale: 1:2,500 |

Co-ordinate system: British National Grid EPSG: 27700

© Vattenfall Wind Power Ltd 2018. Contains Ordnance Survey data
© Crown copyright and database rights 2018 Ordnance Survey 0100031673



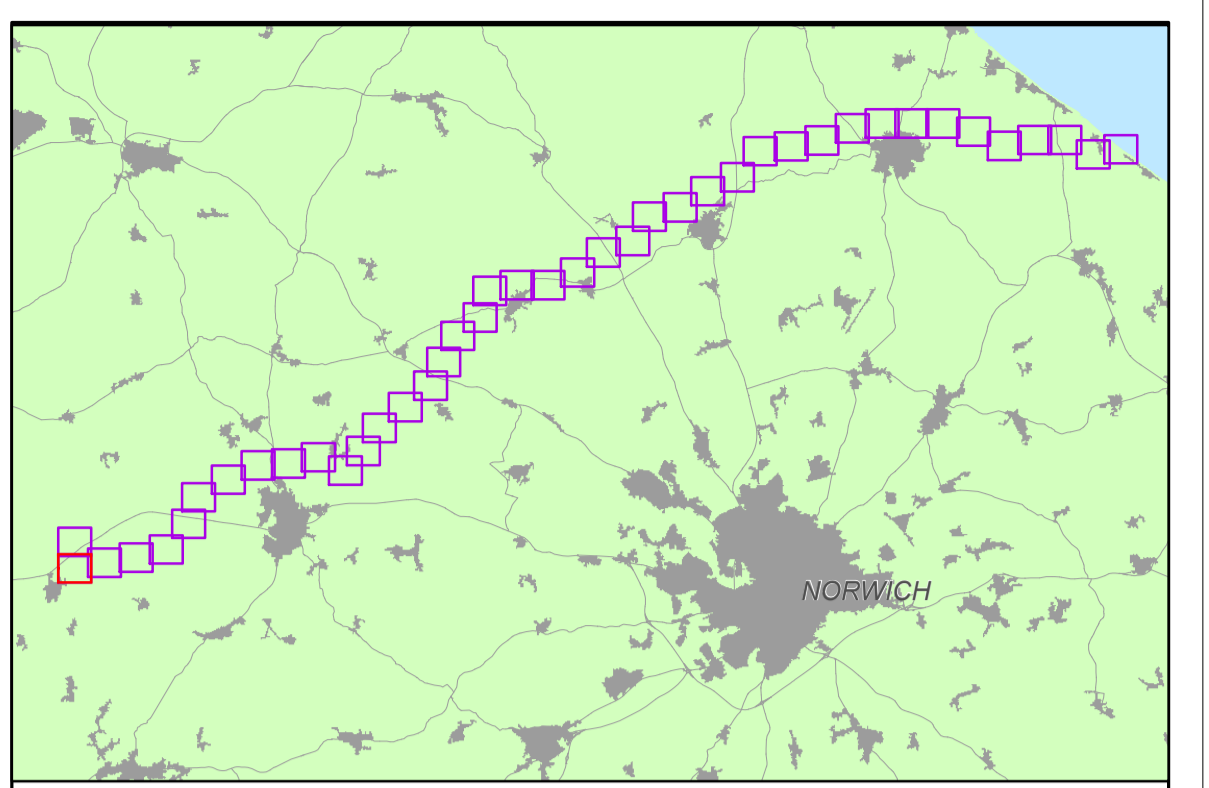
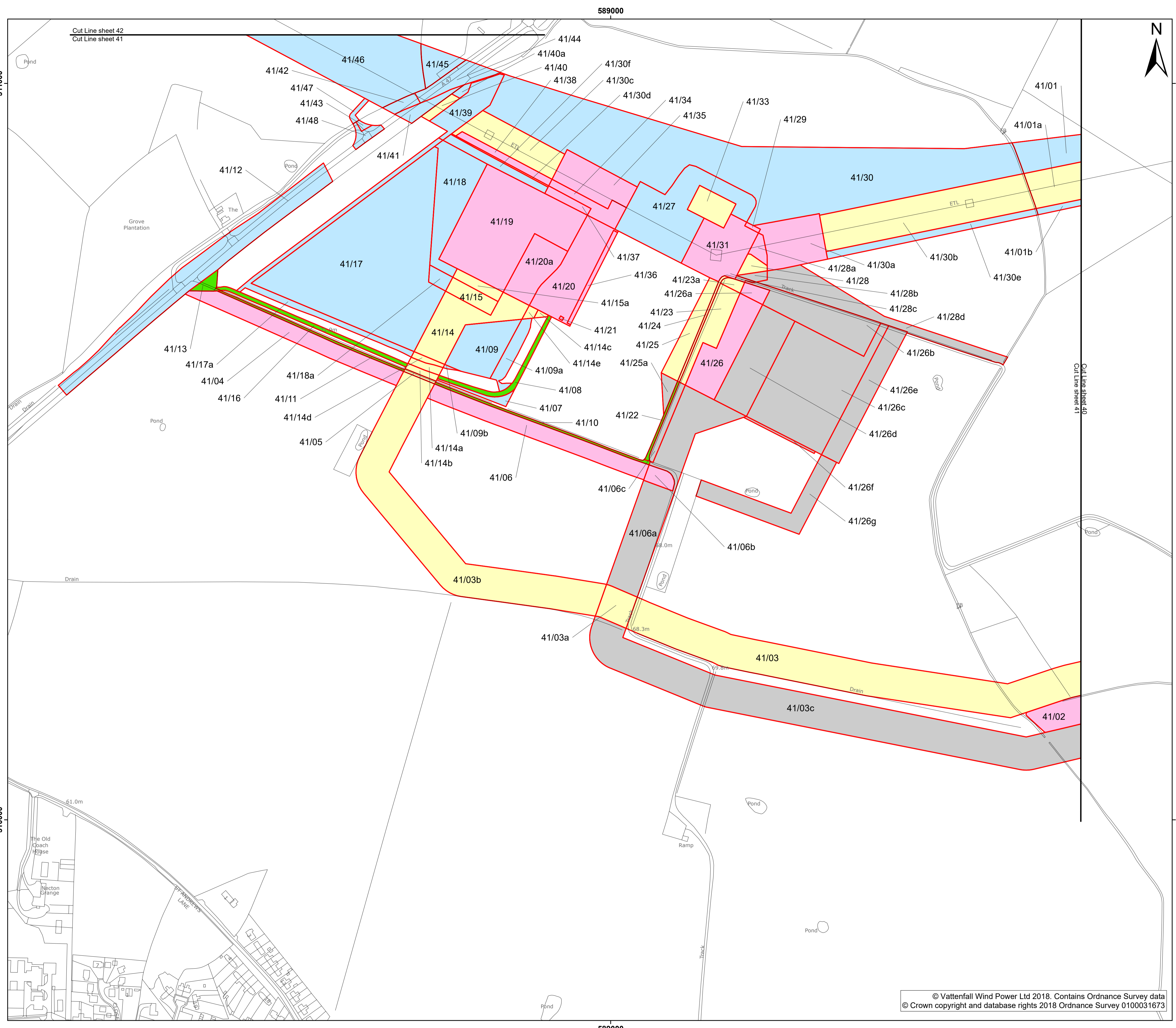

Type of Interest Required

- Temporary Rights
- Acquisition of Permanent New Rights, Access Only
- Permanent Freehold Acquisition
- Acquisition of Permanent New Rights
- Land not required

Version 4 - October 2020

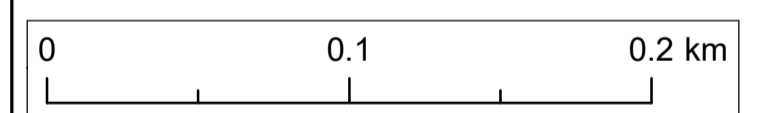

| | |
|--|--------------------------------------|
| Project: Norfolk Boreas Offshore Wind Farm | Report: Development Consent Order |
|--|--------------------------------------|

Title:
**Land Plans
Scenario 2
Sheet 41b**

| | | | | | |
|-----------------|----------------------|--|----------------|-------------|-------------------|
| Doc Ref: 2.2 | APFP Ref: 5(2)(i) | Drawing No: 006_ARDG_Norfolk_B_LP_S240b42b_Rev8 | | | |
| Revision: 03 | Date: 06/10/2020 | Drawn: JH | Checked: AP | Size: A1 | Scale: 1:2,500 |

Co-ordinate system: British National Grid EPSG: 27700

© Vattenfall Wind Power Ltd 2018. Contains Ordnance Survey data
© Crown copyright and database rights 2018 Ordnance Survey 0100031673

